

ABX100 EXP VIEW	CW33496-101	REV.E
DR BY: 陶建榮	DATE: 2010/1/20	SHEET 1 OF 2

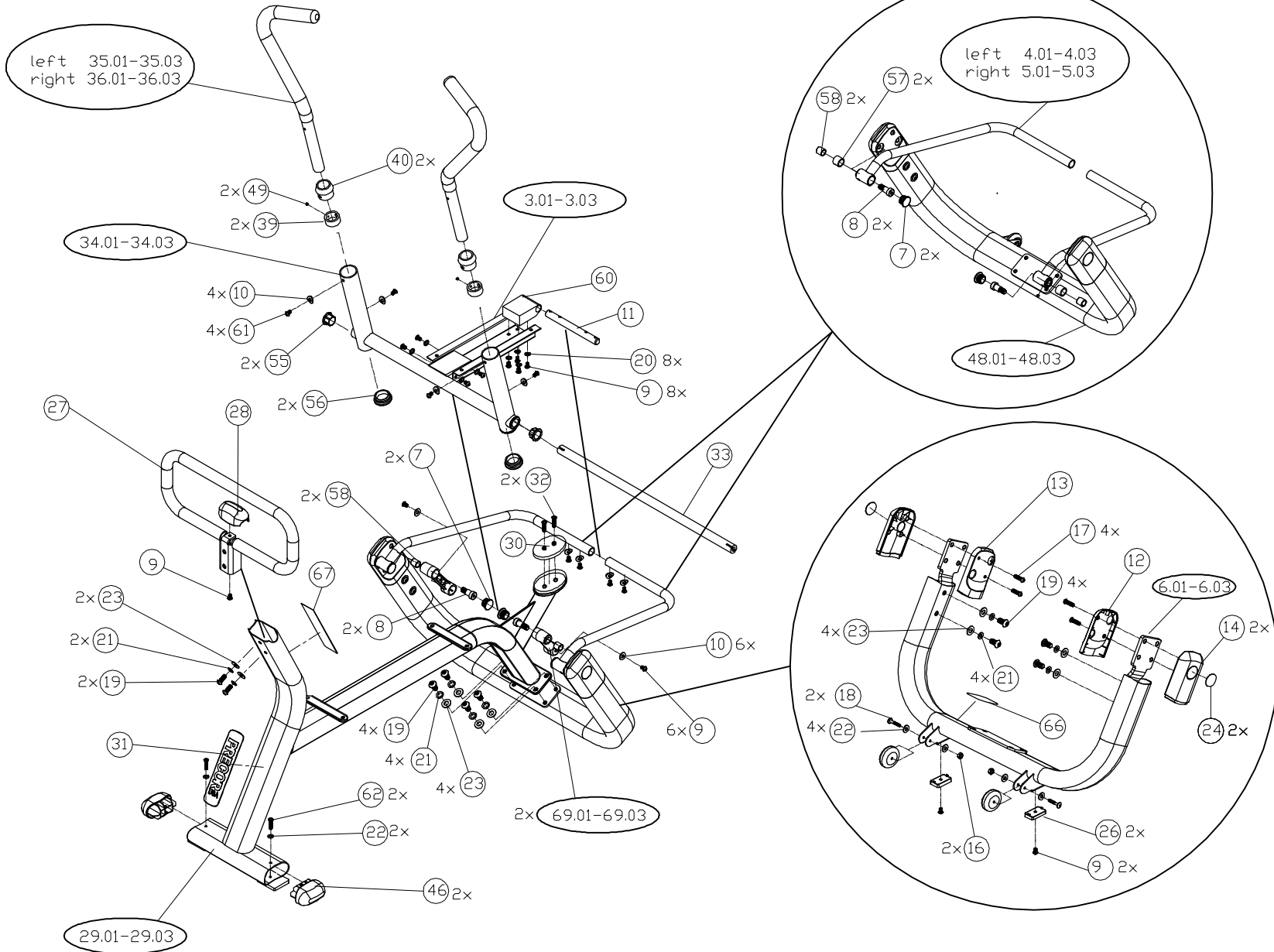

ABX100 EXP VIEW	CW33496-101	REV.E
DR BY: 陶建榮	DATE: 2010/1/19	SHEET 2 OF 2

AB-X100 Abench (serial code BYYC)

Part Number	Description	Bubble Number
PPP00CWAP070179101	BODY PAD ASSEMBLY, ABX100, BLACK UP	1
PPP00CWAP070180101	HEAD PAD ASSEMBLY, ABX100, BLACK UP	2
PPP0000AP022254101	BACK PAD CHANNEL SUPPORT, WHITE	3.01
PPP0000AP022256101	STEEL BLOCK, WHITE	3.01
PPP0000AP041559101	WELDMENT, SUPPORT BAR LEFT, SKYE WH	4.01
PPP0000AP043625101	WELDMENT, SUPPORT BAR LEFT, SKY WHI	4.01
PPP0000AP043626XXX	WELDMENT, SUPPORT BAR RIGHT,UNPAINT	5
PPP0000AP041560101	WELDMENT, SUPPORT BAR RIGHT, SKYE W	5.01
PPP0000AP043626101	WELDMENT, SUPPORT BAR RIGHT, SKY WH	5.01
PPP0000AP022255101	PLATE,SKYE WHITE	6
PPP0000AP022255101	PLATE,SKYE WHITE	6.01
PPP0000AP060358101	ROUND END CAP	7
PPP00CWAP060358101	ROUND END CAP	7
PPP0000AP050505101	SHOULDER SCREW, 1/2 DIAM X .75 - .8	8
PPP0000AP050505731	SHOULDER SCREW, 15.9MM DIAM X .20.5	8
PPP000CWRANN050075	BOLT, SHOULDER, 1/2-13 X 5/8 X 3/4	8
PPP00000TAJE031075	SCREW,BTHD,5/16-18X3/4, E-COAT,NYLO	9
PPP00000TAJN031050	SCREW,BTHD,5/16-18X1/2, E-COAT	9
PPP00000TAJN031075	SCREW,BTHD,5/16-18X3/4, E-COAT	9
PPP000CWTAYN031050	SCREW, BUTTON HEAD, BLK XYLAN, 5/16	9
PPP0000WBSJN008002	WASHER, CURVED, 8MMX22MMX2MM	10
PPP00CWWSJN008001	WASHER, CURVED, 8MMX22MMX1MM, BEC	10
PPP0000AP031095101	SHAFT	11
PPP0000AP031095741	SHAFT	11
PPP0000AP060766101	INNER PLASTIC COVER RIGHT	12
PPP0000AP060767101	INNER PLASTIC COVER LEFT	13
PPP0000AP060768101	OUTER PLASTIC COVER	14
PPP0000AP060769101	ORANGE WHEEL	15
PPP00000KDJN031027	LOCKNUT, FULL, 5/16-18,BLK E-COAT	16
PPP000CWKDYN031025	LOCKNUT, NYLON INSERT, FULL, UNC, 5	16
PPP00000TAJN031125	SCREW,BTHD,5/16-18X1-1/4, E-COAT	17
PPP000CWTAYN031125	SCREW, BUTTON HEAD, BLK XYLAN, 5/16	17
PPP00000TAJN031175	SCREW,BTHD,5/16-18X1-3/4, E-COAT	18
PPP000CWTAYN031175	SCREW, BUTTON HEAD, BLK XYLAN, 5/16	18
PPP00000TAJN038100	SCREW, BTHD, 3/8-16 X 1-1, E-COAT	19
PPP000CWTAYN038100	SCREW, BUTTON HEAD, BLK XYLAN, 3/8	19
PPP00000WKJN008002	WASHER, METRIC, PLAIN, 8MM, E-COAT	20
PPP0000WBWJN008002	WASHER, 8MM SPLIT LOCK, E-COAT	20
PPP000CWVALYN031008	WASHER, SPLIT, 5/16 ID, BL	20
PPP0000WBWJN010002	WASHER, 10MM SPLIT LOCK, E-COAT	21
PPP000CWVALYN038009	WASHER, SPLIT, 3/8 ID, BLK XYLAN	21
PPP00000WKJN008002	WASHER, METRIC, PLAIN, 8MM, E-COAT	22
PPP0000WBWJN008002	WASHER, 8MM SPLIT LOCK, E-COAT	22
PPP000CWVBKN031007	WASHER, FLAT, TYPE A, SAE, 5/16 ID	22
PPP00000WKJN010002	WASHER, FLAT, 10MM X 25MM X 2.0MM,	23
PPP000CWVBKN038007	WASHER, FLAT, TYPE A, SAE, 3/8 ID	23
PPP00APMD000265101	LOGO BADGE	24
PPP0000AP060764101	PLASTIC FOOT	26
PPP00CWAP060764101	PLASTIC FOOT	26
PPP0000AP041557721	WELDMENT, FOOT REST, WRINKLE BLACK	27

PPP00CWAP041557101	FOOT REST	27
PPP0000AP060765101	END CAP, FOOTREST	28
PPP00CWAP060765101	END CAP, FOOTREST	28
PPP00CWAP041579131	MAIN FRAME, TITANIUM	29
PPP0000AP041579101	WELDMENT, MAIN FRAME, SKYE WHITE	29.01
PPP00CWAP041579101	MAIN FRAME, WHITE	29.01
PPP0000AP060762102	OVAL RUBBER PAD W/HOLES	30
PPP00CWAP060762101	OVAL RUBBER PAD	30
PPP00CWAP100130101	PRECOR LOGO BADGE	31
PPP000CWTAYN031075	SCREW, BUTTON HEAD, BLK XYLAN, 5/16	32
PPP00CWMAJYN031075	SCREW, FLAT HEAD, SOCKET, BLK XYLA	32
PPP00CWAP041558101	HANDLEBAR FIXTURE TUBE, WHITE	34.01
PPP0000AP041663101	HANDLEBAR, LEFT, WHITE	35.01
PPP00CWAP041663101	HANDLEBAR, LEFT, WHITE	35.01
PPP0000AP041664101	HANDLEBAR, RIGHT, WHITE	36.01
PPP00CWAP041664101	HANDLEBAR, RIGHT, WHITE	36.01
PPP00CWAP050526101	PIVOT ARM	37
PPP0000AP050526101	PIVOT ARM, SKYE WHITE	37.01
PPP00CWAP060489101	ROUND END CAP	38
PPP0000AP031182741	SPACER 43X33X20L	39
PPP0000AP050527102	ALUMINUM COLLAR	39
PPP0000AP031182101	SPACER 43X33X20L	40
PPP0000AP050527102	ALUMINUM COLLAR	40
PPP000CWTAYN031075	SCREW, BUTTON HEAD, BLK XYLAN, 5/16	41
PPP00000CW10186105	WRENCH, ALLEN 6MM (4-5/8)	42
PPP00000CW10186110	WRENCH, ALLEN, 8MM	43
PPP00000CW10186117	WRENCH, ALLEN 5MM	44
PPP00000CW10186118	WRENCH, ALLEN 3MM	45
PPP00CWAP060763101	PLASTIC END CAP	46
PPP0000WBLJN008002	WASHER, FLAT, 8 X 16 X 1.6T, BEC	47
PPP00CW WBLJN008001	WASHER, FLAT, 8 X 14 X 1.6T, BEC	47
PPP000CWEANN025025	SCREW, SET, SCKT, CUP POINT, 1/4-28	49
PPP00APMG000079101	WARNING LABEL	50
PPPCWAPMD000266101	ABX EXERCISE - CAUTION LABEL	51
PPP00000044880101	SPACER, STEP, 1.0ID,1.5LIP	55
PPP0000AP060489101	ROUND END CAP	56
PPP0000AP080146101	BUSHING	58
PPP0000AP050630721	ALUMINUM BLOCK, WRINKLE BLACK	60
PPP00000TAJE031075	SCREW,BTHD,5/16-18X3/4, E-COAT,NYLO	61
PPP00000TAJN031225	SCREW,BTHD,5/16-18X2.25, E-COAT	62
PPP00APMG000079101	WARNING LABEL	66
PPPCWAPMD000266101	ABX EXERCISE - CAUTION LABEL	67
PPP0000AP200385101	ASSY, PIVOT ARM, SKYE WHITE	69.01
PPP00000CW58007101	CS KIT, ABX100, HANDLEBAR REPAIR	100
PPPCWAPB326HWKT101	AB-X100 HARDWARE KIT	200
PPPCWAPB326HWKT102	AB-X100 HARDWARE KIT	200
PPP00000CW33469101	LITERATURE KIT, AB-X100	999